

Lowell Joint School District

Tradition of Excellence Since 1906

The Home of Scholars and Champions



WELCOME HOME TO LOWELL JOINT

October 2, 2023



Measure LL 1.0+

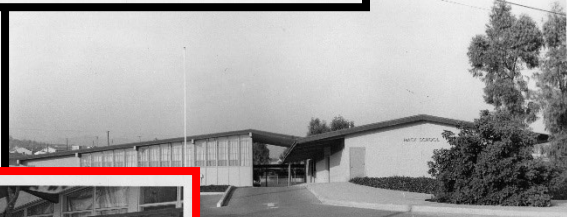
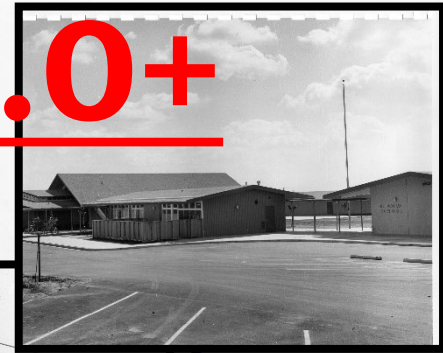

“CARE TAKERS OF A LEGACY”

Lowell Joint ...





WHO WE ARE....

CORE VALUES

"...the philosophy of the school room in one generation will be the philosophy of government in the next." Abraham Lincoln
"...the education of one generation develops the leaders and government of the next generation..." Mrs. Janet B. Averil

Moral and Civic Values: The Board of Trustees of the Lowell Joint School District subscribes to the belief that public education must foster in students an understanding of the moral values and civic responsibilities that form the foundation of our American Heritage and Society. It is important that all school personnel promote in students the acceptance of commonly held Core Values of right and wrong, concern for the welfare of others, and respect for democratic practices. On September 11, 2017, the Board of Trustees endorsed the following list of moral and civic values and the accompanying definitions which are stated as behaviors exemplified by students and staff living up to these values.



EXCELLENCE

Exhibits patience and hard work in achieving goals; works, learns, and pursues constructive goals, even in the face of adversity.



PERSONAL INTEGRITY

Exhibits sound moral principles, virtues, and good character demonstrating honesty and trustworthiness in the community.



SOCIAL RESPONSIBILITY & RESPECT

Treats others justly, fairly, and with dignity; shows high regard for others and treating them as they would like to be treated. Affirms the worth of self, others, property, and the environment through attitudes and actions. Accepts the necessity of being accountable and the consequences of individual actions, reactions, and decisions; honors commitments; demonstrates an active commitment to the welfare of self and others.



RESPECT FOR NATIONAL HERITAGE

Exhibits a value of and commitment to our American National Heritage and the public good; works for the community and cooperates with others; respects and participates in the democratic process; observes all laws and rules; and resolves conflicts peacefully.



FAMILY - TEAMWORK

Works well together combining individual talents and strengths, supporting each other, and then working cooperatively to achieve mutual objectives. Demonstrates caring, concern, and sensitivity; exhibits tolerance; treats others politely, mercifully, and with respect and dignity; and renders service when needed.



TRADITIONAL VALUES

Tells truth; does not cheat, intentionally mislead, or steal; possesses the courage to behave and conduct interactions with integrity; exhibits consistency between words and actions; behaves in a fair and straightforward manner; and conscientiously pursues and scrutinizes evidence that supports the truth.

Mission Statement The Lowell Joint School District is committed to providing a strong academic program of 21st Century skills with a well-rounded program of diverse and innovative subject offerings. All District Schools emphasize the importance of education, the family, and traditional values. We stress the value of personal integrity, social responsibility, and a respect for our national heritage. The Lowell Joint School District envisions a culture where technology empowers all members of the school community to achieve success and expand learning beyond the walls of the classroom. All stakeholders will utilize technology to become highly competent in a technological world through continuous improvement in academics, career, and life.

LOWELL JOINT SCHOOL DISTRICT

A Tradition of Excellence Since 1906

GUIDING GOALS

"...the education of one generation develops the leaders and government of the next generation..." Mrs. Janet B. Averil

DISTRICT GOAL 1: Academic Excellence - Learning for All Students

Vision: Every student experiences educational success at the highest levels of achievement. We believe that each student has a unique ability to learn in an environment that is enriched with a challenging curriculum, where learning is modeled and expectations are both known and high. We expect all students to demonstrate continued and improved academic achievement through Collaboration, Communication, Critical thinking, and Creativity, to be college and career ready, and to become lifelong learners.



DISTRICT GOAL 2: Safe, Orderly, Positive, Respectful Learning Environments

Vision: All campuses provide an aesthetic, orderly environment that is organized to ensure learning. We believe in a collaborative spirit of place where all feel safe, welcomed, valued, and respected. We foster a culture that promotes the emotional health, safety, well-being and involvement of students, staff, family and community.



DISTRICT GOAL 3: Highly Qualified Staff Providing High Quality Service

Vision: All staff possesses the appropriate knowledge, skills, and attitudes needed to provide high quality services leading to high quality results. We believe that high quality service is achieved when staff is well trained, proactive, responsive, and collaborative. We attract, train, and retain high performing staff that actively engage, collaborate, and support students in effective instruction and the use of current technologies.



DISTRICT GOAL 4: School/Family/Community Partnerships & Communication

Vision: High quality student learning is supported by partnerships. We believe these partnerships are enhanced through effective communication and collaboration. We establish a culture which encourages positive relationships among our students, staff, and families as well as educational, business, and community partners. We believe these partnerships and communication must be nurtured to optimize opportunities for learning and personal growth for students.



DISTRICT GOAL 5: Acquisition & Allocation of Resources to Support Fiscal Excellence

Vision: Resources are focused to achieve district goals. We believe that public schools deserve sufficient resources to achieve high quality student learning. We believe that efficiency, transparency, and cost-effective practices must characterize District and school operations to ensure that resources are aligned and applied to achieve established goals. We are committed to remaining fiscally solvent by effectively managing resources and pursuing new revenue sources.



The Lowell Joint School District is committed to providing a strong academic program of 21st Century skills with a well-rounded program of diverse and innovative subject offerings. All District Schools emphasize the importance of education, the family, and traditional values. We stress the value of personal integrity, social responsibility, and a respect for our national heritage. The Lowell Joint School District envisions a culture where technology empowers all members of the school community to achieve success and expand learning beyond the walls of the classroom. All stakeholders will utilize technology to become highly competent in a technological world through continuous improvement in academics, career, and life. On October 7, 2017 the Board of Trustees reaffirmed these national goals and accompanying descriptions which serve as the overarching vision for the Lowell Joint School District.

LOWELL JOINT SCHOOL DISTRICT

A Tradition of Excellence Since 1906



WHERE WE ARE GOING.....



LOWELL JOINT SCHOOL DISTRICT

"A Tradition of Excellence Since 1906"

"Home of Scholars and Champions"

GUIDING GOALS – VISION 2030 ROADMAP



Board Re-Adopted
October, 2017
October, 2018
October, 2019
October, 2020
October, 2021
October 2022

"What do we want our students & staff to master?"

ACADEMIC EXCELLENCE-LEARNING FOR ALL STUDENTS

- Classroom Instruction: EDI, GLAD, Write From Begin, Thinking Maps
- Instructional Curriculum: Instructional Pacing Guide, Benchmark Assessments (Summative, Formative), Report Cards
- Achievement /Dashboard: Student, Classroom, School, District
- C.A.R.E. – Internship Program
- REACH QUEST FLEX/SOAR Programs (Intervention & Recognition)
- Instructional Technology: Learning Tool
- LJSD-MTSS: Multi-Tier System of Support
- LJSD PASS PORT Project (21st Century College & Career)
- Character Education & Patriotism



"How do we know if they have mastered it?"

SCHOOL/FAMILY/COMMUNITY PARTNERSHIP & COMMUNICATION

- Parent University
- Comprehensive Communication & Marketing Plan
- Cal State Fullerton College of Education Partnership
- BIOLA College of Educational Partnership
- BIOLA College of Visual & Performing Arts Partnership
- Lowell Educational Foundation: partnership and recognition
- Legends & Legacy Project
- Instructional Technology: Communication Tool
- School District Award Applications: Golden Bell, Magna, Distinguished School, Exemplary Arts, Exemplary CTE,
- State of the District Presentations: City Councils, Service Clubs, PTSA, et.
- "Lowell Talk" – "Side-by-Side"/"You're My Why"



"What to we do for those who have or have not mastered it?"

HIGHLY QUALIFIED STAFF-HIGH QUALITY SERVICE

- WELCOME BACK RALLY & PD- WINTER RALLY & PD - SPRING CELEBRATION & PD
- Instructional Technology: Instructional Tool
- LJSD Staff Awards Recognition: Medal of Honor, Impact, Retirement Vases, Year of Service pins,
- LJSD Induction Program (Lighthouse)
- Welcome Home to LJSD Program: *Culture-Climate-Commitment*
- LJSD Master Teacher Series
- Review of HR protocols (certificated and classified)
- TOP GUN Academy: Instructional Leader PD and Future Leaders
- Re-design staff website
- Comprehensive Systemic Prof. Development Plan



ACADEMIC EXCELLENCE-ACADEMIC PROGRAMING

- Instructional Technology: Instructional Tool- STEAM Innovation Labs (TK-6th), Co Google Classroom
- Engineering-Coding-Robotics Pathway (TK-6th) & AP Computer Science (7th- 8th)
- ARTS FOR ALL (TK-6th) and COFA Academy (7th- 8th) & AP Art (7th- 8th)
- Pre-AP Heritage IB Honors Academy (7th-8th)
- The Living Classroom*
- Full-Day Kindergarten & TK & The STUDIO
- LJSD Pre-School Child Development Center
- HORIZONS (Gate High Achievers)
- POWER SOURCE
- Special Education Program- Blue Ribbon Action Team
- CARE – Counseling & Psychologist Internship Program
- HORIZONS Summer Honors Camp
- Lowell Joint Youth Theater
- Lowell Literacy Project
- Dual Language (TK-8th)



ACQUISITION & ALLOCATION OF RESOURCES TO SUPPORT FISCAL EXCELLENCE

- Financial stability
- LJSD Master Facility Plan
- Staff: recruitment, retention, compensation
- LJSD Pre-School Program Child Development Center
- Revised Inter- & Intra- District permit process
- Saturday Enrichment Enhancement/Engagement Program
- Bond Measure (LL)
- Methods to generate revenue
- Virtual Academy & Homeschool Program



SAFE, ORDERLY, POSITIVE, RESPECTFUL LEARNING ENVIRONMENT

- Character Education & Patriotic Educational Program
- Strategic Educational Facility Plan
- LJSD Inter- & Intra- District permit protocol
- PowerSource: after school programming
- Saturday Enrichment Enhancement/Engagement Program
- Review and systemized student code of conduct
- Landscaping enhance., Instructional center, Professional Learning Center
- Enhancement and update of Board Room
- LCAP Surveys: Parent, Staff, Student
- Review and update of Board Policies



Conditions We Control

- Program
- Procedures
- Policies
- Fixed vs Flexible
- Attitude/Approach



GRIT

- Why it Matters:** Showing Up, Distracted by Talent, Effort counts Twice, Grit Grows
- Growing from Inside Out:** Interest, Practice, Purpose, Hope
- Growing from Outside In:** Parenting, Playing Fields, Culture



LJSD CORE VALUES

- Excellence
- Personal Integrity
- Social Responsibility & Respect
- Respect for National Heritage
- Family - Teamwork
- Traditional values



Good To Great

- Good is Enemy of Great
- Level 5 Leadership
- First Who...Then What
- Brutal Facts
- Hedgehog Concept
- Culture of Discipline
- Tech Accelerators
- Flywheel & Doom Loop
- Built to Last



Patriotic

- American Heritage
- Good Citizen
- American form of Government
- Respect for National Heritage





FACILITIES MASTER PLAN 2.0+

REVISED/REFRESH OCTOBER 2023



LOWELL JOINT SCHOOL DISTRICT
A TRADITION OF EXCELLENCE SINCE 1906
"Home of Scholars and Champions"

Facilities Master Plan

PRELIMINARY

SECOND EDITION

August 17, 2023

Care Takers of a Legacy

FRAMEWORK FOR THE NEXT GENERATION - 20 YEARS IN THE MAKING

GHATRODE BRANNON ARCHITECTS GBA

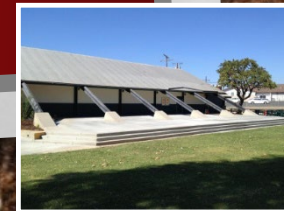

NEW SINGLE STORY BUILDINGS A & B

BUILDING A

(6) 960 S.F. STANDARD CLASSROOMS

GIRL'S RESTROOM W/4 TOILET STALLS

BOY'S RESTROOM W/2 TOILET STALLS & 2 URINALS.

(1) SINGLE OCCUPANCY STAFF RESTROOM

BUILDING B

(6) 960 S.F. STANDARD CLASSROOMS

GIRL'S RESTROOM W/4 TOILET STALLS

BOY'S RESTROOM W/2 TOILET STALLS & 2 URINALS.

(1) SINGLE OCCUPANCY STAFF RESTROOMS

- EXPAND NORTHWEST PARKING AND RECONDITION NORTH PARKING
- PARKING LOT LIGHTING
- CENTRAL QUAD STAGE AND PAVING
- LUNCH SHELTER 30' X 60'

PARKING LOT B

STANDARD PARKING STALLS = 59
 ACCESSIBLE PARKING STALLS = 3
 TOTAL PARKING STALLS = 62

PARKING LOT A

STANDARD PARKING STALLS = 40
 ACCESSIBLE PARKING STALLS = 2
 TOTAL PARKING STALLS = 42

BEACH BLVD.

NADA ST.



EL PORTAL ELEMENTARY

EL PORTAL ELEMENTARY 2.0+

NEW SINGLE STORY BUILDINGS A & B

BUILDING A

(6) 960 S.F. STANDARD CLASSROOMS

GIRL'S RESTROOM W/4 TOILET STALLS

BOY'S RESTROOM W/2 TOILET STALLS & 2 URINALS.

(1) SINGLE OCCUPANCY STAFF RESTROOM

BUILDING B

(6) 960 S.F. STANDARD CLASSROOMS

GIRL'S RESTROOM W/4 TOILET STALLS

BOY'S RESTROOM W/2 TOILET STALLS & 2 URINALS.

(1) SINGLE OCCUPANCY STAFF RESTROOMS

NORTHWESTERN VIEW

▼ 3D VISUALIZATION



AUGUST 2023 PHOTO ▲





- EXPAND NORTHWEST PARKING AND RECONDITION NORTH PARKING
- PARKING LOT LIGHTING
- CENTRAL QUAD STAGE AND PAVING
- LUNCH SHELTER 30' X 60'

CENTRAL QUAD

AUGUST 2023 PHOTO ▼

▲ 3D VISUALIZATION



JORDAN ELEMENTARY



▲ 3D VISUALIZATION

1.0 & 2.0
DONE

COMPLETED IN 2022

ADMINISTRATION BUILDING

- RECEPTION
- PRINCIPAL OFFICE
- NURSE OFFICE WITH RESTROOM
- STAFF RESTROOM
- STAFF WORKROOM WITH MAIL BOXES
- STAFF LOUNGE
- STORAGE

BUILDING A

- (1) P-K 1,350 S.F. WITH RESTROOMS & WORKROOM
- (1) T-K 1,350 S.F. WITH RESTROOMS & WORKROOM

BUILDING B

- (6) STANDARD 960 S.F. CLASSROOMS W/GLASS SLIDING PANELS FOR COLLABORATION.
- SINGLE OCCUPANCY GIRL'S RESTROOM
- SINGLE OCCUPANCY BOY'S RESTROOM
- (2) SINGLE OCCUPANCY STAFF RESTROOMS
- CUSTODIAN ROOM & UTILITY ROOM
- STORAGE

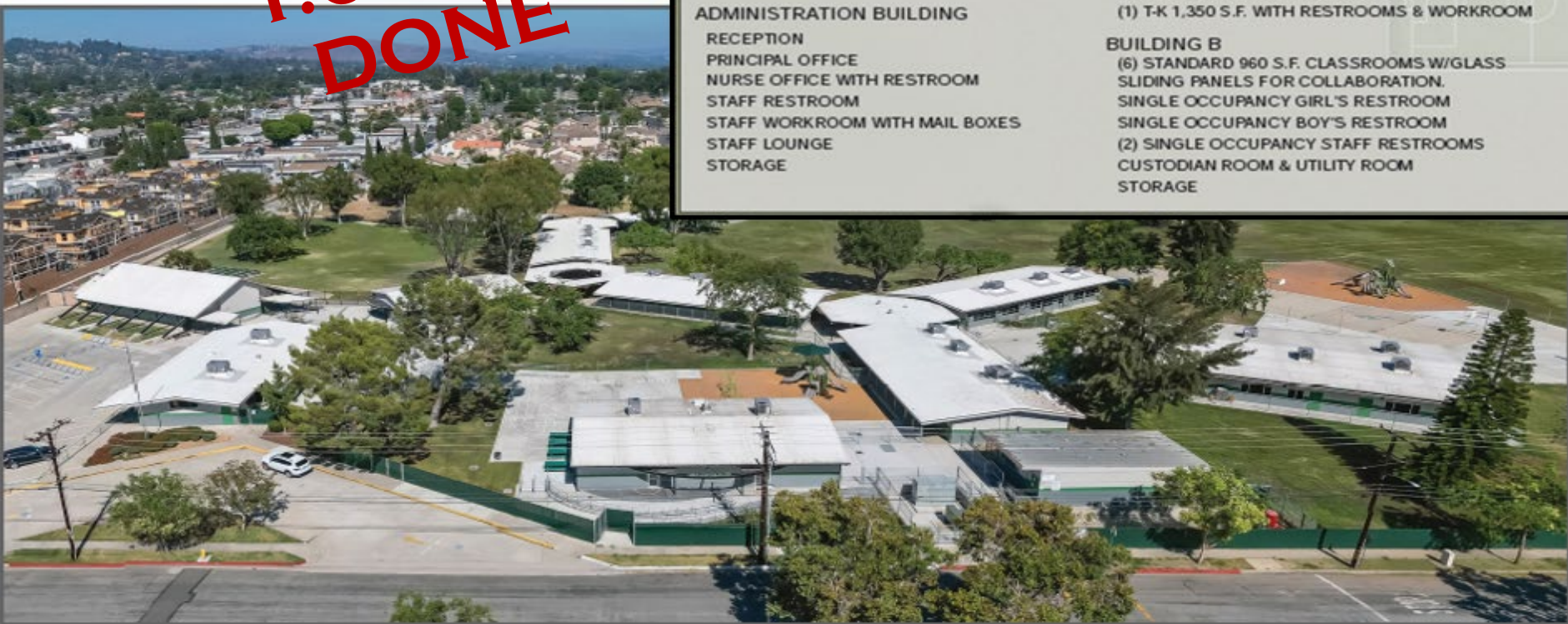

REMAINING IMPROVEMENTS

- 1 MODIFY (E) DROP-OFF FOR GREATER EFFICIENCY
- 2 (E) CONCRETE PAD TO REMAIN
- 3 SOUTH & EAST FENCES NEED UPGRADING
- 4 (E) CONCRETE PAD TO REMAIN
- 5 (E) WESTERN FENCE NEEDS GENERAL UP-KEEP
- 6 NEW AMPHITHEATER



▲ 3D VISUALIZATION

ADMIN/ENTRY

▲ AUGUST 2023 PHOTO ▼



▲ 3D VISUALIZATION

NORTHERN VIEW

▲ AUGUST 2023 PHOTO ▼



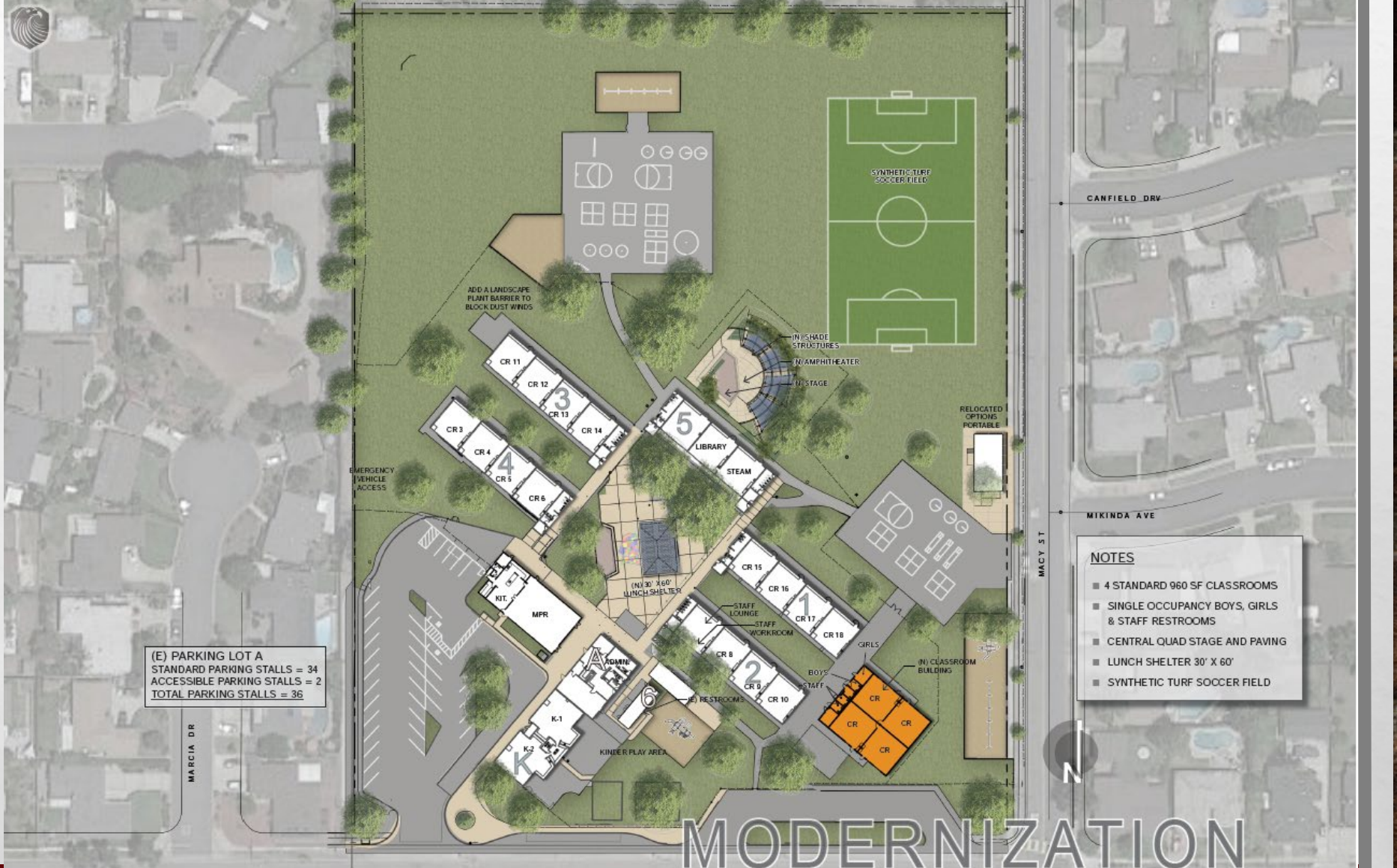

(E) PARKING LOT A
 STANDARD PARKING STALLS = 34
 ACCESSIBLE PARKING STALLS = 2
 TOTAL PARKING STALLS = 36

- NOTES**
- 4 STANDARD 960 SF CLASSROOMS
 - SINGLE OCCUPANCY BOYS, GIRLS & STAFF RESTROOMS
 - CENTRAL QUAD STAGE AND PAVING
 - LUNCH SHELTER 30' X 60'
 - SYNTHETIC TURF SOCCER FIELD

MODERNIZATION

MACY ELEMENTARY

MACY ELEMENTARY 2.0+



SOUTHEASTERN VIEW

AUGUST 2023 PHOTO ▼

▲ 3D VISUALIZATION

NOTES

- 4 STANDARD 960 SF CLASSROOMS
- SINGLE OCCUPANCY BOYS, GIRLS & STAFF RESTROOMS
- CENTRAL QUAD STAGE AND PAVING
- LUNCH SHELTER 30' X 60'
- SYNTHETIC TURF SOCCER FIELD





CENTRAL QUAD AND AMPHITHEATER

▼ AUGUST 2023 PHOTO



3D VISUALIZATION ▲

NOTES

- 4 STANDARD 960 SF CLASSROOMS
- SINGLE OCCUPANCY BOYS, GIRLS & STAFF RESTROOMS
- CENTRAL QUAD STAGE AND PAVING
- LUNCH SHELTER 30' X 60'
- SYNTHETIC TURF SOCCER FIELD





NEW CLASSROOM BUILDING

AUGUST 2023 PHOTO ▼

▲ 3D VISUALIZATION

NOTES

- 4 STANDARD 960 SF CLASSROOMS
- SINGLE OCCUPANCY BOYS, GIRLS & STAFF RESTROOMS
- CENTRAL QUAD STAGE AND PAVING
- LUNCH SHELTER 30' X 60'
- SYNTHETIC TURF SOCCER FIELD





SILVER GROVE DR.

GROVEDALE DR.

GROVEDALE DR.



NOTES

- (6) STANDARD 960 SF CLASSROOMS
- (4) STUDENT AND STAFF RESTROOMS
- RECONDITION NORTH PARKING LOT
- EXPAND NORTH PARKING LOT



(N) SHADE STRUCTURES
(N) AMPHITHEATER

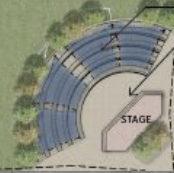

BLDG A & B



NEW CLASSROOM BUILDING

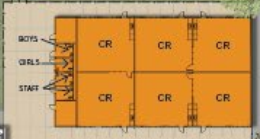

(E) PLAYGROUND



EXPANDED PARKING / DROP-OFF AREA



BLDG C



BLDG D

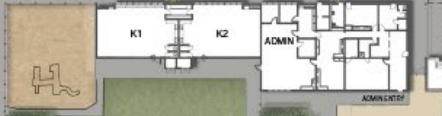

BLDG E



(E) OPTIONS PORTABLE



DROP-OFF DROP-OFF

ADD A SECOND DRIVE
APPROACH FROM
PARKING LOT

EXPANDED PARKING LOT
STANDARD PARKING STALLS = 58
ACCESSIBLE PARKING STALLS = 2
TOTAL PARKING STALLS = 60

MODERNIZATION

MEADOW GREEN ELEMENTARY

MEADOW GREEN ELEMENTARY 2.0+

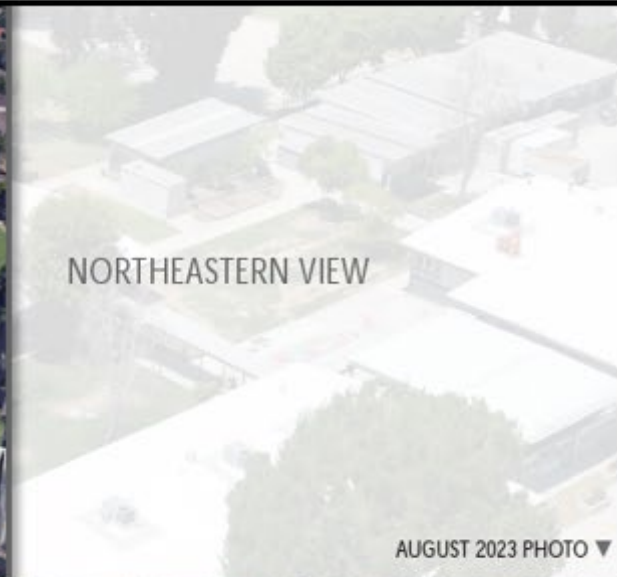

AUGUST 2023 PHOTO ▼

▲ 3D VISUALIZATION

NOTES

- (6) STANDARD 960 SF CLASSROOMS
- (4) STUDENT AND STAFF RESTROOMS
- RECONDITION NORTH PARKING LOT
- EXPAND NORTH PARKING LOT





PROPOSED
AMPHITHEATER

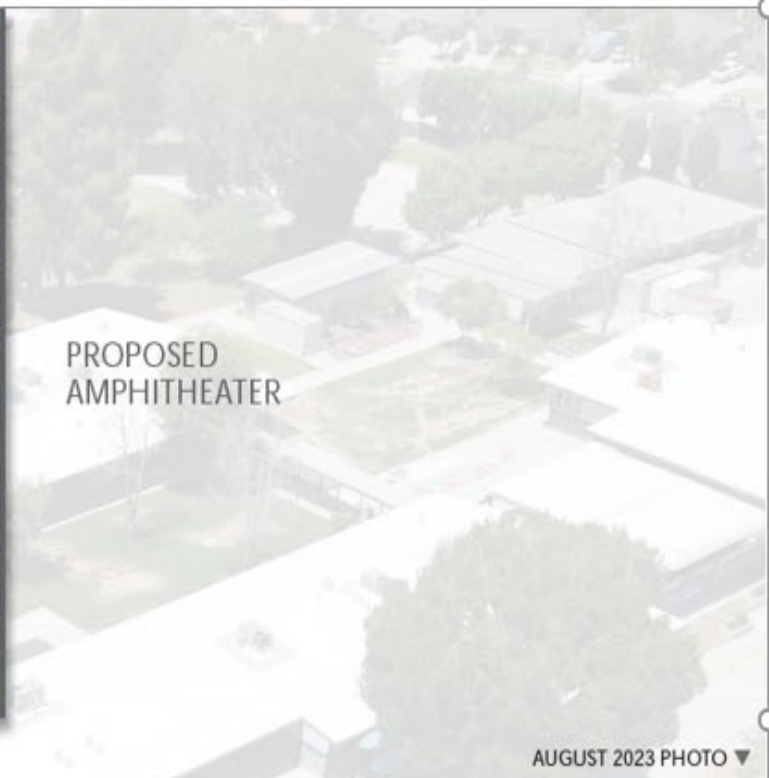

AUGUST 2023 PHOTO ▼

▲ 3D VISUALIZATION



NOTES:

- (5) STANDARD 960 SF CLASSROOMS
- GIRLS RESTROOM W/ 4 TOILET STALLS
- BOYS RESTROOM W/ 2 TOILET STALLS AND 2 URINALS
- PARKING LOT LIGHTING
- LUNCH SHELTER 30' X 60'

PARKING LOT B
STANDARD PARKING STALLS = 32
ACCESSIBLE PARKING STALLS = 2
TOTAL PARKING STALLS = 34

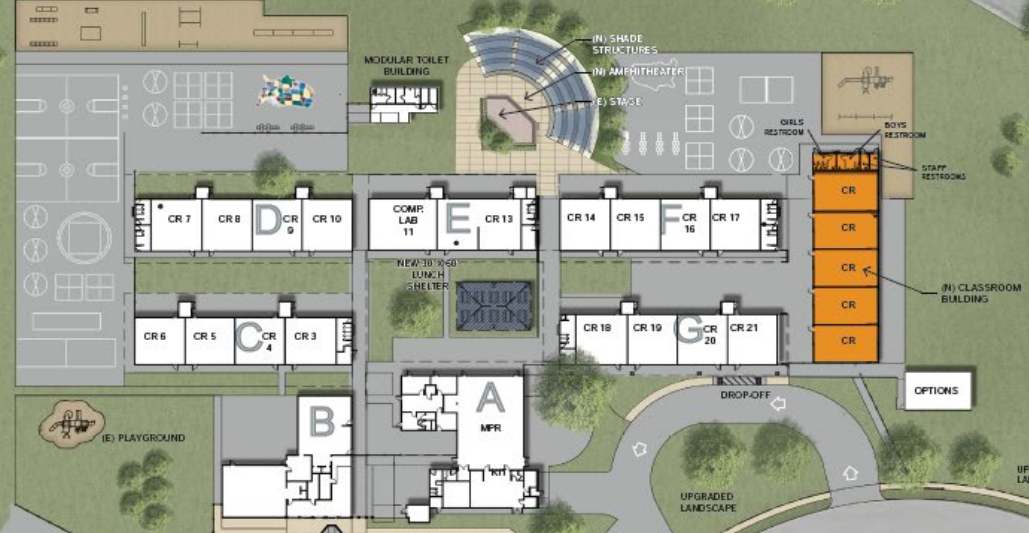

MODERNIZATION

OLITA ELEMENTARY

OLITA ELEMENTARY

2.0+



AUGUST 2023 PHOTO ▼

▲ 3D VISUALIZATION

NOTES:

- (5) STANDARD 960 SF CLASSROOMS
- GIRLS RESTROOM W/ 4 TOILET STALLS
- BOYS RESTROOM W/ 2 TOILET STALLS AND 2 URINALS
- PARKING LOT LIGHTING
- LUNCH SHELTER 30' X 60'



NEW CLASSROOM BUILDING,
AMPHITHEATER AND SHADE STRUCTURE



3D VISUALIZATION ▲

▼ AUGUST 2023 PHOTO





▲ 3D VISUALIZATION



NEW SHADE STRUCTURE

AUGUST 2023 PHOTO ▼



PARKING LOT B
 STANDARD PARKING STALLS = 8
 ACCESSIBLE PARKING STALLS = 1
 TOTAL PARKING STALLS = 9

PARKING LOT A
 STANDARD PARKING STALLS = 58
 ACCESSIBLE PARKING STALLS = 3
 TOTAL PARKING STALLS = 61

**NEW GYMNASIUM/
 PERFORMING ARTS BUILDING**
 (18,745 S.F.)

- (1) MAIN COURT W/ BLEACHER SEATING
- (2) PRACTICE COURTS
- STAGE W/ THEATER LIGHTS
- DRESSING ROOMS & COSTUME STORAGE
- (1) SINGLE OCCUPANCY RESTROOM
- THEATER CLASSROOM 1,400 S.F.
- DANCE STUDIO 1,400 S.F.
- SCENE SHOP W/ OUTDOOR WORK AREA
- WOMEN'S RR W/4 TOILET STALLS
- MEN'S RR W/2 STALLS AND 2 URINALS

SINGLE STORY CLASSROOM BUILDING
 (8) STANDARD CLASSROOMS 960 S.F.
 GIRL'S RR W/3 TOILET STALLS
 BOY'S RR W/2 STALLS AND 1 URINALS
 (1) SINGLE OCCUPANCY STAFF RESTROOM
 ELECTRICAL ROOM

SYNTHETIC TURF SOCCER FIELD

TIGRINA AVE

WOODBRIER DR

DS AVE

LARRYLYN DR

BLDG A

BLDG D

BLDG C

BLDG B

BLDG F

BLDG E

BLDG H

BLDG G

GYMNASIUM
 PERFORMING ARTS

CLASSROOM BUILDING

MODERNIZATION

RANCHO-STARBUCK

RANCHO-STARBUCK

2.0+



▲ 3D VISUALIZATION

NEW GYMNASIUM/ PERFORMING ARTS BUILDING (18,745 S.F.)

- (1) MAIN COURT W/ BLEACHER SEATING
- (2) PRACTICE COURTS
- STAGE W/ THEATER LIGHTS
- DRESSING ROOMS & COSTUME STORAGE
- (1) SINGLE OCCUPANCY RESTROOM
- THEATER CLASSROOM 1,400 S.F.
- DANCE STUDIO 1,400 S.F.
- SCENE SHOP W/ OUTDOOR WORK AREA
- WOMEN'S RR W/4 TOILET STALLS
- MEN'S RR W/2 STALLS AND 2 URINALS

SINGLE STORY CLASSROOM BUILDING
(8) STANDARD CLASSROOMS 960 S.F.
GIRL'S RR W/3 TOILET STALLS
BOY'S RR W/2 STALLS AND 1 URINALS
(1) SINGLE OCCUPANCY STAFF RESTROOM
ELECTRICAL ROOM

SYNTHETIC TURF SOCCER FIELD



NEW PAC / GYM / PARKING

Power Finish

Math Help

Tue & Wed

3:20 - 4:00



**NEW GYMNASIUM/
PERFORMING ARTS BUILDING
(18,745 S.F.)**

- (1) MAIN COURT W/ BLEACHER SEATING
- (2) PRACTICE COURTS
- STAGE W/ THEATER LIGHTS
- DRESSING ROOMS & COSTUME STORAGE
- (1) SINGLE OCCUPANCY RESTROOM
- THEATER CLASSROOM 1,400 S.F.
- DANCE STUDIO 1,400 S.F.
- SCENE SHOP W/ OUTDOOR WORK AREA
- WOMEN'S RR W/4 TOILET STALLS
- MEN'S RR W/2 STALLS AND 2 URINALS

SINGLE STORY CLASSROOM BUILDING
(8) STANDARD CLASSROOMS 960 S.F.
GIRL'S RR W/3 TOILET STALLS
BOY'S RR W/2 STALLS AND 1 URINALS
(1) SINGLE OCCUPANCY STAFF RESTROOM
ELECTRICAL ROOM

SYNTHETIC TURF SOCCER FIELD



RANCHO STARBUCK





CARE TAKERS OF A LEGACY

FRAMEWORK FOR THE NEXT GENERATION...20 YEAR IN THE MAKING

MASTER FACILITY PLAN 2.0+

